

ATTACHMENT B

300-foot Radius Map & Address Label



NOTIFICATION PACKAGE

1481 N Hollenbeck Ave, Covina

APNs 8408-020-015

INCLUDES:

300' OWNER LIST

300' RADIUS MAP

(2) SETS OF GUMMED LABELS (IN CITY PKG)

NOTARIZED CERTIFICATION

COUNT: 53 (duplicates consolidated)

PREPARED 02/06/2026

FILE #1241QB

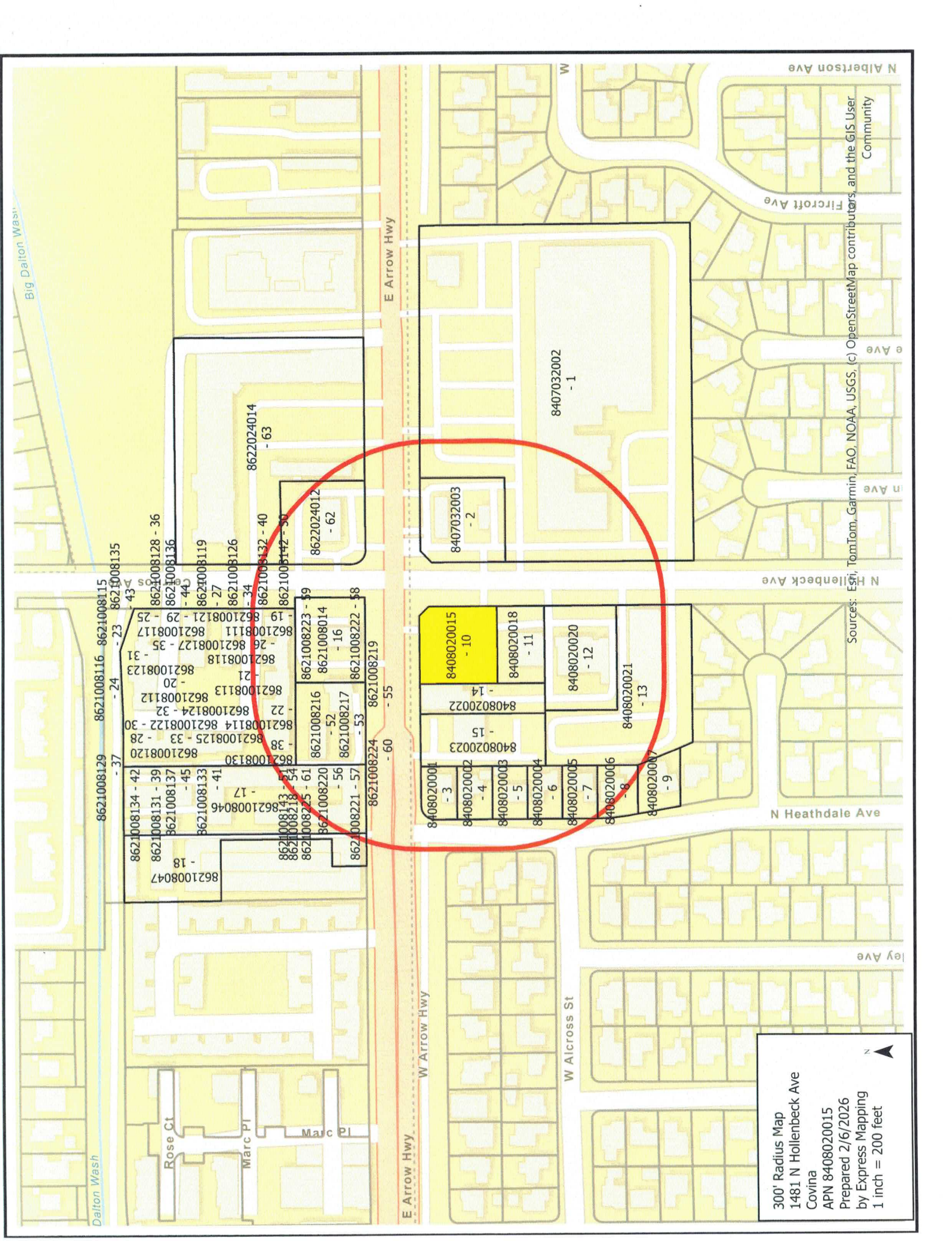

Dalton Wash

Rose Ct

Marc Pl

Marc Pl

E Arrow Hwy

W Arrow Hwy

W Alcross St

300' Radius Map
 1481 N Hollenbeck Ave
 Covina
 APN 8408020015
 Prepared 2/6/2026
 by Express Mapping
 1 inch = 200 feet



Sources: Esri, TomTom, Garmin, FAO, NOAA, USGS, (c) OpenStreetMap contributors, and the GIS User Community

8621008129 -37
 8621008116 -24
 8621008115 -23
 8621008135 -43

8621008134 -42
 8621008131 -39
 8621008137 -45
 8621008133 -41
 8621008046 -17
 8621008047 -18

8621008128 -36
 8621008136 -44
 8621008119 -27
 8621008126 -34
 8621008132 -40
 8621008142 -30

8621008114 -33
 8621008125 -38
 8621008120 -20
 8621008113 -21
 8621008124 -32
 8621008122 -30

8621008130 -38
 8621008216 -52
 8621008217 -53
 8621008223 -39
 8621008014 -16
 8621008222 -58

8621008224 -60
 8621008219 -55

8408020001 -3
 8408020002 -4
 8408020003 -5
 8408020004 -6
 8408020005 -7
 8408020006 -8
 8408020007 -9

8408020022 -14
 8408020018 -11
 8408020020 -12
 8408020021 -13

8408020023 -15
 8408020015 -10

8408020024 -16
 8408020025 -17
 8408020026 -18
 8408020027 -19

8408020028 -20
 8408020029 -21
 8408020030 -22

8408020031 -23
 8408020032 -24
 8408020033 -25

8408020034 -26
 8408020035 -27
 8408020036 -28

8408020037 -29
 8408020038 -30
 8408020039 -31

8408020040 -32
 8408020041 -33
 8408020042 -34

8408020043 -35
 8408020044 -36
 8408020045 -37

8408020046 -38
 8408020047 -39
 8408020048 -40

8408020049 -41
 8408020050 -42

8622024014 -63

8622024012 -62

8407032003 -2

8407032002 -1

8407032001 -1

8407032000 -1

8407032000 -1

8407032000 -1

8407032000 -1

8407032000 -1

8407032000 -1

8407032000 -1

8407032000 -1

8407032000 -1

8407032000 -1

8407032000 -1

8407032000 -1

8407032000 -1

8407032000 -1

8407032000 -1

8407032000 -1

8407032000 -1

8407032000 -1

8407032000 -1

8407032000 -1

8407032000 -1

8407032000 -1

8407032000 -1

8407032000 -1

8407032000 -1

8407032000 -1

8407032000 -1

8407032000 -1

8407032000 -1

8407032000 -1

8407032000 -1



Certified Property Owner's List Affidavit

Community Development Department – Planning Division

125 East College Street • Covina, California 91723 • (626) 384-5450 / Fax: (626) 384-5479

Property Description and Certification Statement:

I, Charles Emerson, hereby certify that the attached list contains the names and addresses of all persons to whom property is assessed as they appear on the latest available assessment roll of the County of Los Angeles within the area described and for a distance of **300 feet** from the exterior boundaries of property legally described as:

TRACT # 21240 LOT EX OF STS COM AT NE COR OF NW 1/4 OF SEC 11 T 1S R 10W TH S 170 FT TH W 180 FT TH N 170 FT TH E 180 FT TO BEG PART OF LOT 199

1481 N HOLLENBECK AVE COVINA CA 91722, Parcel # (APN): 8408-020-015

Name (printed): Charles Emerson

Signature:

Title: Employee Express Mapping

Date: _____

SUBSCRIBED AND SWORN TO BEFORE ME THIS 6th DAY OF February, 20 26

NOTARY PUBLIC

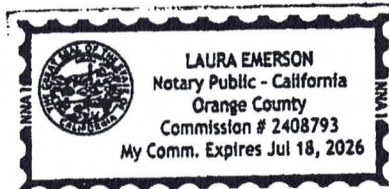

8407-032-002 (1)
Jr Mp li Llc
11111 Santa Monica Blvd #520
Los Angeles CA 90025

8407-032-003 (2)
Bost Land Llc
9302 Garfield Ave
South Gate CA 90280

8408-020-001 (3)
Ruben V Asuncion
1484 N Heathdale Ave
Covina CA 91722

8408-020-002 (4)
Concepcion Cortez
1474 N Heathdale Ave
Covina CA 91722

8408-020-003 (5)
Victor Grajeda
13803 N Anada St
Baldwin Park CA 91706

8408-020-004 (6)
Leonor V Tayag
1458 N Heathdale Ave
Covina CA 91722

8408-020-005 (7)
Miriam A Monterrosa
1450 N Heathdale Ave
Covina CA 91722

8408-020-006 (8)
Daw Htar Wai
1440 N Heathdale Ave
Covina CA 91722

8408-020-007 (9)
Dalton & Tram Phan
19744 E Cameron Ave
Covina CA 91724

8408-020-015 (10)
Hollenbeck At Arrow Hwy Llc
2141 Stratford Cir
Los Angeles CA 90077

8408-020-018 (11)
Michael A Ibrahim
4655 N Conwell Ave
Covina CA 91722

8408-020-020 (12)
De Los Reyes Felipe V Co Tr
21806 Pinto Way
Walnut CA 91789

8408-020-021 (13)
Alliance Medical Management Inc
554 E San Bernardino Rd #200
Covina CA 91723

8408-020-022 (14)
Raffy Melikian
8324 Edwin St
Rancho Cucamonga CA 91730

8408-020-023 (15)
Mustapha Chaker M And Sawsan Trs
536 W Arrow Hwy #202
Covina CA 91722

8621-008-014 (16)
Dritsopoulos George Co Tr
7710 Brookmill Rd
Downey CA 90241

8621-008-046 (17)
Mb Equity Llc
Po Box 661904
Arcadia CA 91066

8621-008-047 (18)
Calvo Family Housing Limited
1619 W Garvey Ave N #201
West Covina CA 91790

8621-008-111 (19)
Joseph Difiore
821 S Cerritos Ave #7
Azusa CA 91702

8621-008-112 (20)
Daniel G & Alicia D Bartlett
821 S Cerritos Ave #6
Azusa CA 91702

8621-008-113 (21)
Debbie L Rubio
821 S Cerritos Ave #5
Azusa CA 91702

8621-008-114 (22)
David G & Myrna A Escobar
821 S Cerritos Ave #4
Azusa CA 91702

8621-008-115 (23)
Erik A & Janice Mairina
821 S Cerritos Ave #3
Azusa CA 91702

8621-008-116 (24)
Juan & Sylvia Padilla
821 S Cerritos Ave #2
Azusa CA 91702

8621-008-117 (25)
Rene P & Ingrid P Bravo
821 S Cerritos Ave #1
Azusa CA 91702

8621-008-118 (26)
Carmen T Lewis
821 S Cerritos Ave #33
Azusa CA 91702

8621-008-119 (27)
Julio C & Cindy C Castro
821 S Cerritos Ave #32
Azusa CA 91702

8621-008-120 (28)
Kristine Mkrtyan
821 S Cerritos Ave #31
Azusa CA 91702

8621-008-121 (29)
Bryan & Cai Hannah N Hoang
821 S Cerritos Ave #30
Azusa CA 91702

8621-008-122 (30)
Rosemarie Alvarez
821 S Cerritos Ave #29
Azusa CA 91702

8621-008-123 (31)
Rosemary Phung
821 S Cerritos Ave #28
Azusa CA 91702

8621-008-126 (34)
Beverly D Simpson
821 S Cerritos Ave #25
Azusa CA 91702

8621-008-129 (37)
Michael & Karen A Carnakis
821 S Cerritos Ave #22
Azusa CA 91702

8621-008-132 (40)
Thuy Trang Hoang
1606 W Cameron Ave
West Covina CA 91790

8621-008-135 (43)
Lorraine A Zitouni
821 S Cerritos Ave #16
Azusa CA 91702

8621-008-138 (46)
Domingo & Veronica Barragan
821 S Cerritos Ave #13
Azusa CA 91702

8621-008-141 (49)
Zhenyuan Zhu
821 S Cerritos Ave #10
Azusa CA 91702

8622-024-012 (62)
Gse Properties Llc
29501 Canwood St #200
Agoura Hills CA 91301

8621-008-124 (32)
Joan Lim
821 S Cerritos Ave #27
Azusa CA 91702

8621-008-127 (35)
Melissa Figueroa
821 S Cerritos Ave #24
Azusa CA 91702

8621-008-130, multiple (38,50)
Tom Alice Trust/Carlton & Donna Tom
684 Barnum Way
Monterey Park CA 91754

8621-008-133 (41)
Oscar & Edith Llanos
821 S Cerritos Ave #18
Azusa CA 91702

8621-008-136 (44)
Christopher & Georgina R Gray
733 Bellgrove St
La Verne CA 91750

8621-008-139 (47)
Jianqiao & Wang Yue Ying Zhang
821 S Cerritos Ave #12
Azusa CA 91702

8621-008-143 (51)
Javier Morales
1120 S Fetterly Ave
Los Angeles CA 90022

8622-024-014 (63)
Luxor Properties Inc
4751 Wilshire Blvd #203
Los Angeles CA 90010

8621-008-125 (33)
Manuel Chavira
1873 Wildrose Ave
Pomona CA 91767

8621-008-128 (36)
Monique Broadnax
821 S Cerritos Ave #23
Azusa CA 91702

8621-008-131 (39)
Francisco J & Jamie S Marengo
821 S Cerritos Ave #20
Azusa CA 91702

8621-008-134 (42)
Saul Barajas
576 W Calaveras St
Altadena CA 91001

8621-008-137 (45)
Irene A Baker
821 S Cerritos Ave #14
Azusa CA 91702

8621-008-140 (48)
Howard Y & Mil Yue Tse
1553 Atoll
West Covina CA 91790

8621-008-016, multiple (52-61)
Woodcroft St Housing Assoc. LP
2815 Camino Del Rio S #350
San Diego CA 92108