

ATTACHMENT C

300-feet Radius Map & Address Label



Certified Property Owner's List Affidavit

Community Development Department – Planning Division

125 East College Street • Covina, California 91723 • (626) 384-5450 / Fax: (626) 384-5479

Property Description and Certification Statement:

I, Jason Boone, hereby certify that the attached list contains the names and addresses of all persons to whom property is assessed as they appear on the latest available assessment roll of the County of Los Angeles within the area described and for a distance of **300 feet** from the exterior boundaries of property legally described as:

TR = 41841 * That Por in Tra 3021 of Lot 1

Name (printed):

Jason Boone

Signature:

[Signature]

Title:

Owner

Date:

1-30-25

SUBSCRIBED AND SWORN TO BEFORE ME THIS 30 DAY OF January, 20 25

[Signature]

NOTARY PUBLIC

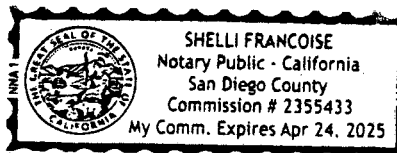

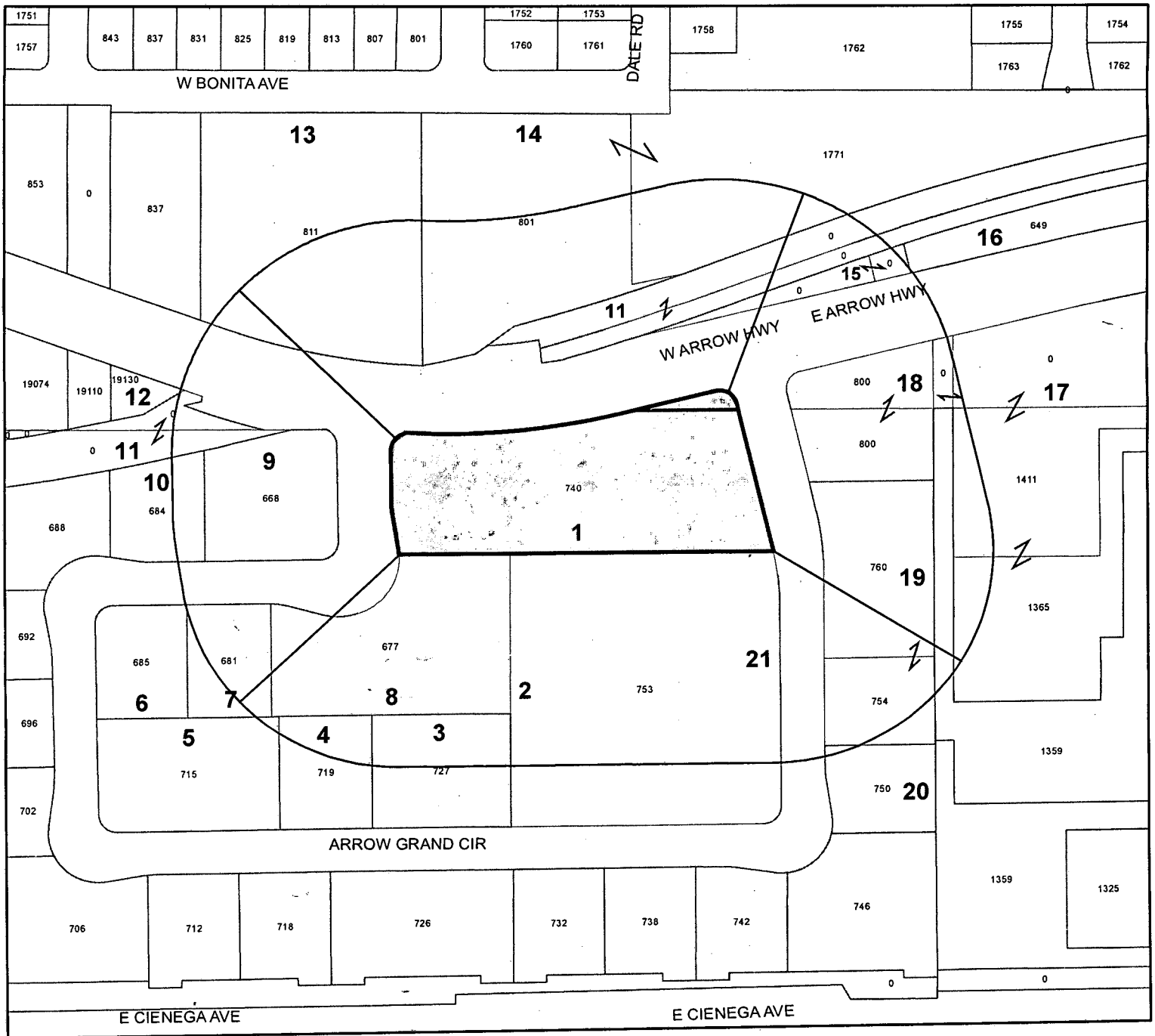

SCALE: 1" = 200'

RADIUS MAP
754 E ARROW HWY, STE D, E, F
COVINA, CA 91722
APN: 8405-003-032
300' RADIUS
DATE: 01-30-2025



OWNERSHIP LABELS

754 E ARROW HWY, STE D, E, F
COVINA, CA 91722
300' RADIUS

1
8405-003-032, 033
WLM AH LLC
370 E ROWLAND ST
COVINA CA 91723

2
8405-003-047
CTT TOOLS INC
755 ARROW GRAND CIR
COVINA CA 91722

3
8405-003-034
EMORY W & CLIO FARR
3001 LA VENTANA
SAN CLEMENTE, CA 92672

4
8405-003-039
JDW PROPERTIES LLC
PO BOX 637
SAN DIMAS, CA 91773

5
8405-003-046
BAHADURSINH & DIPTI ASHER
2851 PANORAMA CT
WEST COVINA, CA 91791

6
8405-003-031
ROLF T ANDERSON
545 W PALM DR
GLEN DORA, CA 91741

7
8405-003-038
ARROW GRAND LLC
3444 MULLDAE AVE
SAN PEDRO, CA 90732

8
8405-003-024
EMORY W & CLIO FARR
3001 LA VENTANA
SAN CLEMENTE, CA 92672

9
8405-003-037
MOLANDER LLC
1290 CENTER COURT DR
COVINA, CA 91724

10
8405-003-013
NIKITA KROUT
2833 E MESA DR
WEST COVINA, CA 91791

11
8405-002-907, 908, 8631-011-908, 909
LA COUNTY FLOOD CONTROL DISTRICT
900 S FREMONT AVE
ALHAMBRA, CA 91803

12
8405-002-018
JOSE L & MARIA C GALEANO
1897 PARKSIDE DR
SAN BERNARDINO, CA 92404

13
8631-010-016
RJS FINANCIAL CORP
1151 N AZUSA AVE
COVINA, CA 91722

14
8631-011-027, 019
GLEN DORA GRAND PROPERTY LLC
PO BOX 5004
GLEN DORA, CA 91740

15
8631-011-021, 024
DANIEL M & MARTHA A LUSK
5459 S 188TH RD
PLEASANT HOPE, MO 65725

16
8631-011-025
MYUNGSUK INC
649 W ARROW HWY
GLEN DORA, CA 91740

17
8405-001-037-041
FNL COVINA PARTNERS LLC
433 N CAMDEN DR #820
BEVERLY HILLS, CA 90210

18
8405-003-021, 022
JAN PROPERTY INVESTMENTS LLC
800 E ARROW HWY
COVINA, CA 91722

19
8405-003-043, 028
JVT PROPERTY LLC
8 ANTHEM POINTE CT
HENDERSON, NV 89052

20
8405-003-040
RONALD C & MARILYN J MOWRY
25423 BRASSIE LN
LA VERNE, CA 91750

STIZZY
2001 S ALAMEDA ST
LOS ANGELES, CA 90058